

# Little King Kong Vise

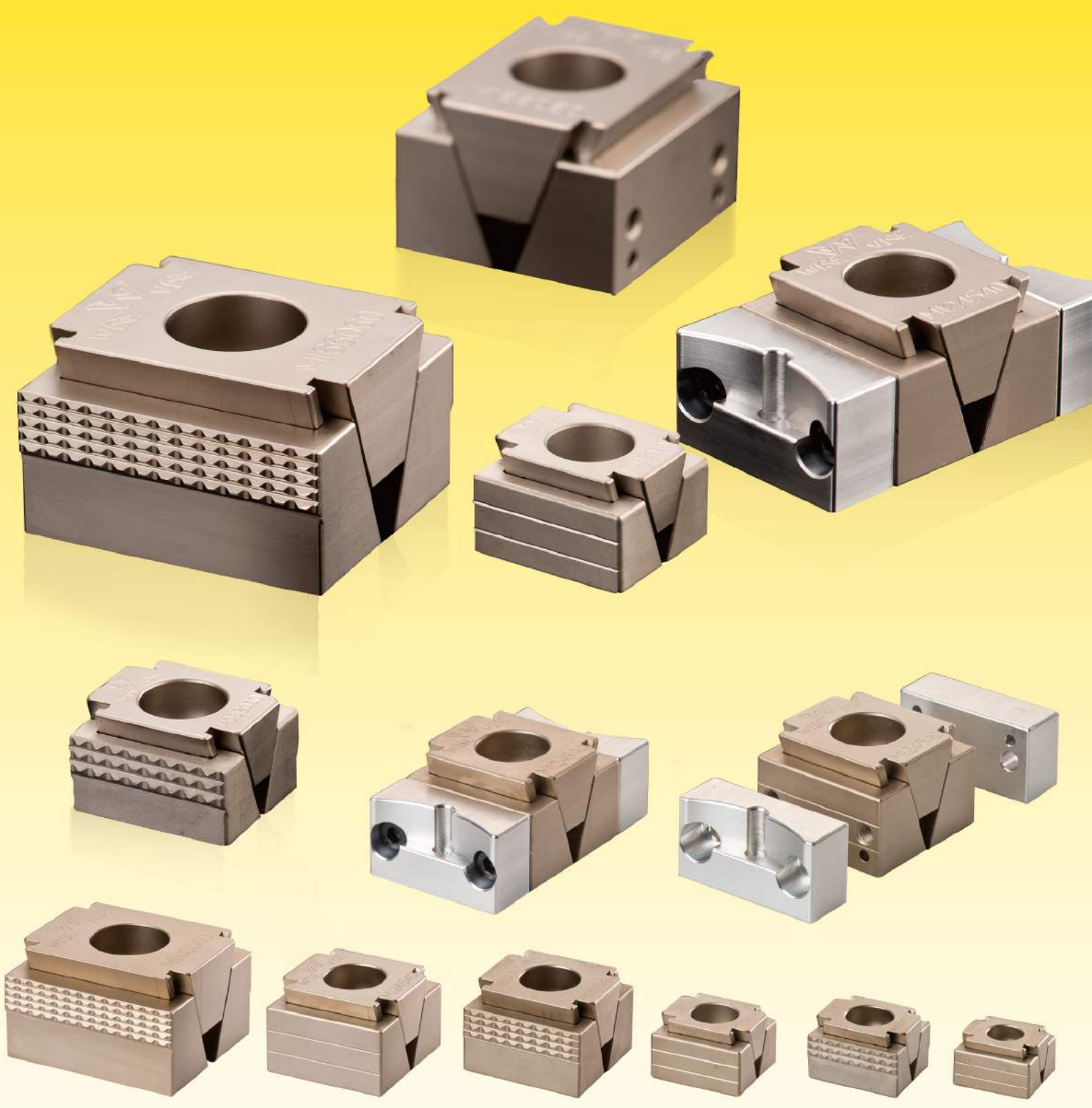

• Hold patents of Taiwan, Japan, U.S.A., Germany, China,...etc.  
Patent protected. Violators will be prosecuted.

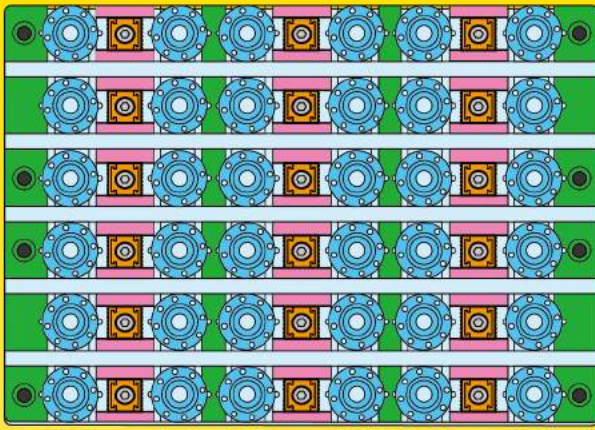



▶ **Little King Kong Vise:**  
An example of fixing round work-piece.

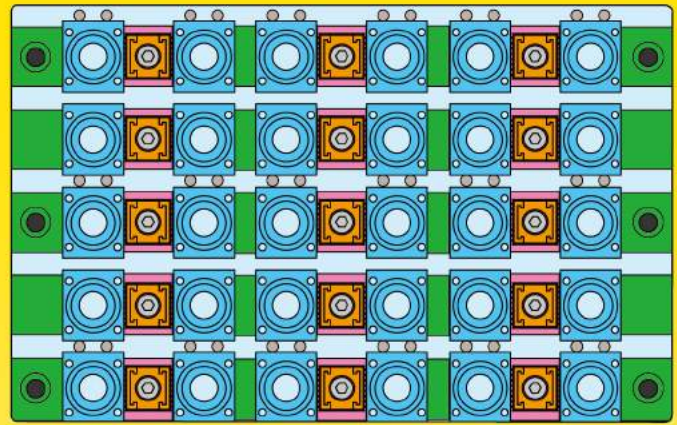

▶ **Little King Kong Vise:**  
An example of fixing square work-piece.

**Blue: Work-piece**  
**Yellow: Vise**  
**Green: Work-holding fixture**  
**Pink: Vise directional fixture**

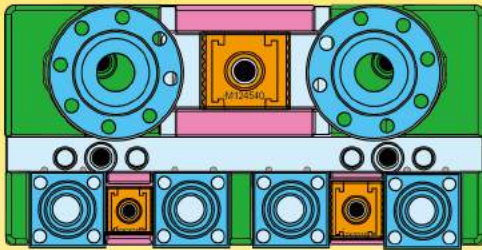

▶ Zero point clamping system is available.  
High-precision exchange of clamping devices,  
fixtures and work-pieces within seconds

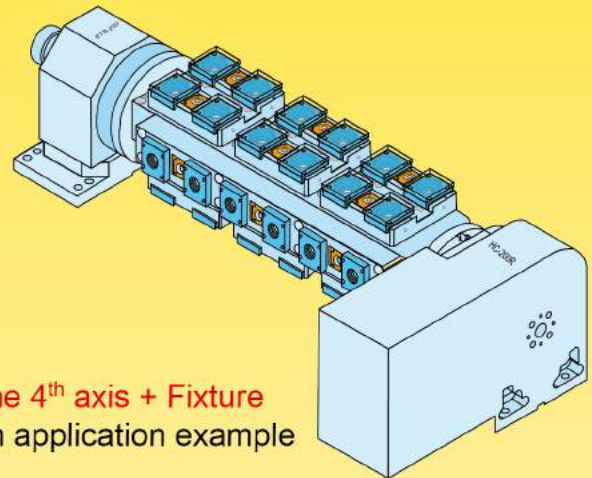

▶ **The 4<sup>th</sup> axis + Fixture**  
An application example

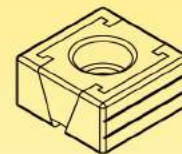
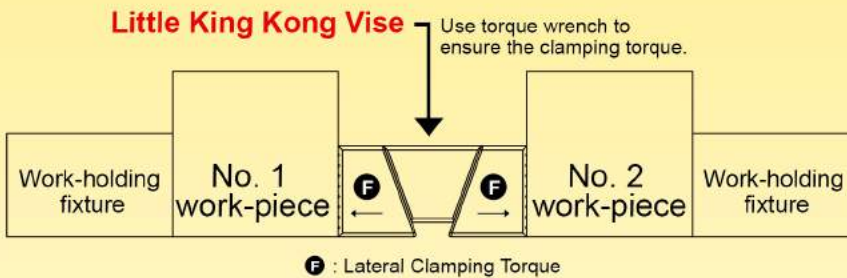

TYPE-A

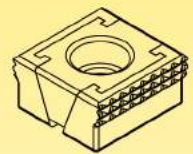

TYPE-B

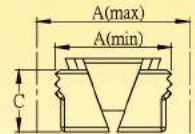
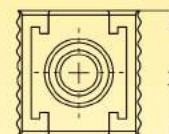

Vise specification	Model	A (mm)			B (mm)	C (mm)	Suitable Screw	Clamping Force (KN)	Surface Hardness (HRC)
		Min.	Rated	Max.					
	M062525	23	25	26	25	12	M6*16	18	48-52
	M083030	27	30	31	30	15	M8*20	25	48-52
	M104040	36	40	42	40	20	M10*25	45	48-52
	M124540	40	45	47	40	22	M12*30	65	48-52
	M166060	54	60	63	60	29	M16*40	110	48-52



**Taiwan, TJR Precision Technology Co., Ltd.**

TEL: +886-4-2562-1267 No. 805, Zhongshan Rd., Shengang Dist., Taichung City 42943, Taiwan (ROC)

**Jiangsu, Jin Tan Jia Precision Machinery Co., Ltd.**

TEL: +86-512-5781 8756

**Shanghai Tan Jia Machinery Equipment Ltd.**

TEL: (86) 21-6806-0545-6 Room 904 No.1100, Kangqiao Rd., Kangqiao Town Pudong New Area, Shanghai City.